

Check before reporting fault



In case the product does not operate normally, check followings first.
If the problem has not been resolved yet, contact the shop you purchased this safe.

Problem	Possible cause	Check and try
No reaction when press Start button.	<ul style="list-style-type: none"> · Adapter connection condition · Circuit failure 	<ul style="list-style-type: none"> · Check the condition of adapter jack connection · Contact the shop who sells this safe.
Touch panel malfunctions.	<ul style="list-style-type: none"> · Touched incorrect point · Other part of the body touches the panel · Foreign substances are in touch panel · Foreign substances are in hands 	<ul style="list-style-type: none"> · Touch desired part correctly · Be careful not to touch the panel with other part of the body · Remove foreign substances from touch panel · Remove foreign substances from hand
No power supply to the safe.	<ul style="list-style-type: none"> · Bad connection of adapter jack 	<ul style="list-style-type: none"> · Reconnect after clean adapter jack
Exceeded number of times for password input.	<ul style="list-style-type: none"> · 5 times of password input error 	<ul style="list-style-type: none"> · When the alarm sound stops 3 minutes after it sounded, input correct password again to return to normal condition.
The door is not opened after input password.	<ul style="list-style-type: none"> · Obstacles around the door 	<ul style="list-style-type: none"> · Remove the obstacles in the direction to which the door is opened.
The door is not closed.	<ul style="list-style-type: none"> · The door has not been closed completely · Obstacles around the door 	<ul style="list-style-type: none"> · Close the door again so that the door is closely pressed to the safe body. · Remove the obstacles in the direction to which the door is opened.
Cannot change password The previous password still exists.	<ul style="list-style-type: none"> · Time has been delayed when change password · Wrong password changing method · Button failure 	<ul style="list-style-type: none"> · No time delay of more than 10 seconds should be made after pressed password change button or Start button.
Forgot password or lost the safe key.	<ul style="list-style-type: none"> · Contact the shop from which you bought this safe. 	

Design revolution that empowers the safe users

A Jewel Box of my life

LUCCELL

LU-7000

User Manual

Precautions

- Please read the precautions carefully before use the product as the purpose of the precautions for safety is to guide safe and right use of the product and prevent unexpected danger or damage.

Warning: Disregarding the warning may cause death or serious injury to user.

Caution: Disregarding the caution may cause injury to user or damage to the product.

Warning

- Handle the safe carefully when you move it as the safe is heavy and you may be injured.
 - Be careful not to be injured by bumping against the edge of the safe.
 - Do not let children play with the safe.
- (Special care is required for children so they will not be stuck in the safe as the safe will be locked automatically when the door is closed.)

Caution

- Be careful not to hurt your fingers when you close the door of the safe.
 - Be careful not to scratch the floor or table when place the safe.
 - The safe may malfunction in case metallic foreign substances are in the touch panel for password.
 - Do not scrape with sharp item or impact the touch panel for password.
- (The touch panel may malfunction when its surface is scraped or may be broken by impact.)
- Do not expose to chemical agents such as petrol, benzene, solvent, acetone and thinner.
- (When the touch panel is exposed to them, it may have unrecoverable damage.)
- Do not heat the product directly. (The touch panel may be deformed to malfunction.)

Standard Components

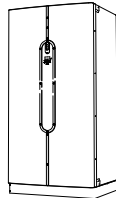
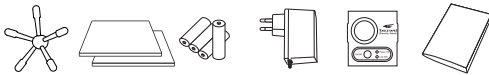

Name of each part

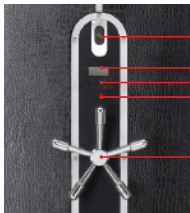

Fingerprint reader
Display screen
Input panel
Start button
Handle

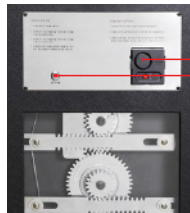

Alarm
Password change button

Using additional functions

Kids-lock function

- Kids-lock is the function which makes touch panel be in locked condition so that children or any person other than the safe user cannot operate the buttons.
- Once the function is activated, password button cannot be operated.

Press Start button for 3 seconds



Act

Activation has been completed.

While kids-lock function is in activation,

press Start button for 3 seconds



dEAct

The function has been cancelled.

Sound volume control

- Volume can be adjusted only when the door is open.
- Volume for guide voice can be adjusted from level 0 to 4 and in case you don't want guide voice, set the level at '0'.
- Beep sounds when you press button. Set '0' if you want no sound.
- For optional fingerprint recognition, password change button should be pressed one more time.

Guide voice volume control	Press password change button for 3 seconds	SEt	Press password change button one time shortly
	UOL 888	Choose volume level among 0~4	Press START button to confirm (DONE)

Watch winder

- Each watch may be different in watch winding direction. Please check the winding direction.



OFF



'1 minutes' counter clockwise rotate, '20 minutes' stop, and then repeat this pattern.



'3 minutes' counter clockwise rotate, '50 minutes' stop, and then repeat this pattern.



'2 minutes' counter clockwise rotate, '30 minutes' stop, '2 minutes' clockwise rotate, '30 minutes' stop, and then repeat this pattern.

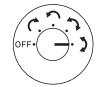

'10 minutes' clockwise rotate, '10 minutes' counter clockwise rotate, and then repeat this pattern. This pattern will be done for 1 hour. After 7 hours later, this pattern will be restarted automatically.

In case power for inner safe is weak or not supplied

1. Insert 4 dry batteries (1.5V) in emergency battery pack.
2. Connect the jack of emergency battery pack to DC 6V plug in the door of the safe.
3. Input password and open the door by pressing Start button.
4. Remove the battery case in the rear part of the door and replace dry batteries with new ones.

Open/Close the door



- Initial password has been set as 1, 2, 3, 4, 5, 6. This password must be changed to use the safe,
- Press Start button two times, and security mode which does not show the numbers can be used,

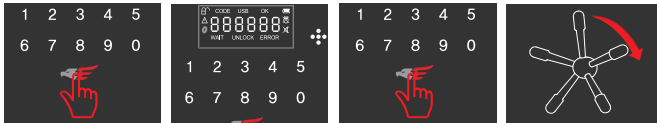

Press Start button ▶ Press password ▶ Press Start button ▶ Turn the handle



- The alarm sounds when password input error takes place 5 times consecutively. At this time, the alarm stops immediately when the password is input. However, if input error repeats 3 times additionally, the alarm sounds for 3 minutes and you have to wait without removing the batteries until the alarm stops before re-try.
- For safe use, alarm sounds 1 minute after the door is opened and when 5 minutes has passed while the door is open, input password once again when alarm sounds,
- Do not fling the door open.

Open/close the door of inner safe

1. Press Start button on the keypad and then press password, (Initial password: 1,2,3,4,5,6)
2. Turn the key clockwise to open the door,

Using fingerprint reader (Up to 10 fingerprints can be stored.)



Press Start button ▶ Slide down fingerprint in fingerprint reader ▶ Open ▶ Turn the handle



- Fingerprint reader operates with password only unless initial fingerprint has been registered.
- In case of wrong touch of fingerprint or using unregistered fingerprint, "Error-04" sign appears.
- Do not use fingerprint reader with foreign substances stained on the fingerprint sensor or finger.
- Fingerprint with scratch or shallow valleys may not be registered or recognized and in case of some unusual fingerprints, fingerprint reader may not response at all.

Registering fingerprint (Up to 10 fingerprints can be stored)



- Registering or deleting fingerprint is possible only while the door is open and you must check if the fingerprint has been successfully registered or deleted before close the door,



- 'FULL' is displayed when all fingerprint ID's have been stored.

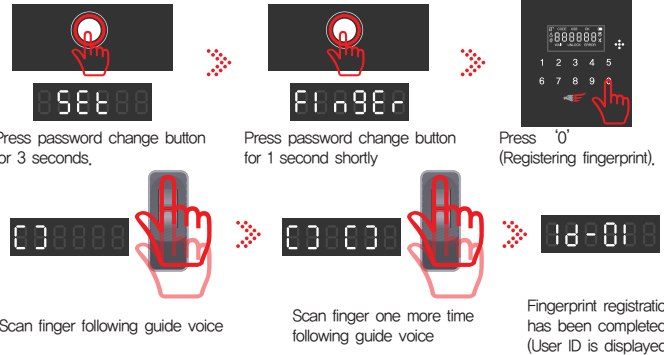

Press password change button for 3 seconds,

Press password change button for 1 second shortly

Press '0'
(Registering fingerprint).

Scan finger following guide voice

Scan finger one more time following guide voice

Fingerprint registration has been completed (User ID is displayed).

Deleting fingerprint



- 'no-F' is displayed if there is no fingerprint to delete.
- All fingerprints are deleted when press 'password change button' one time shortly instead of 'fingerprint ID'.

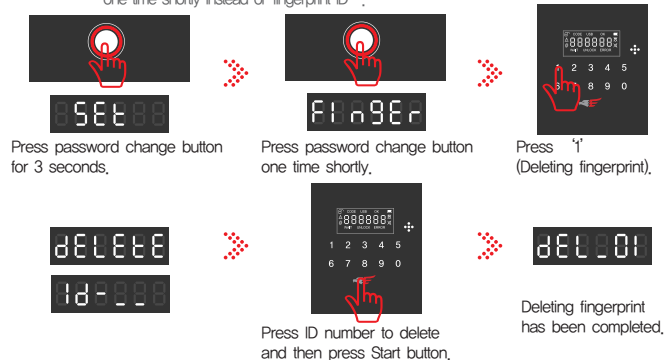

Press password change button for 3 seconds,

Press password change button one time shortly.

Press '1'
(Deleting fingerprint).

Press ID number to delete and then press Start button,

Deleting fingerprint has been completed.

Using the Alarm

- Four 1.5V/AA dry batteries are used as emergency power supply.
- Dry batteries should be equipped in the alarm at all times.

View of the alarm

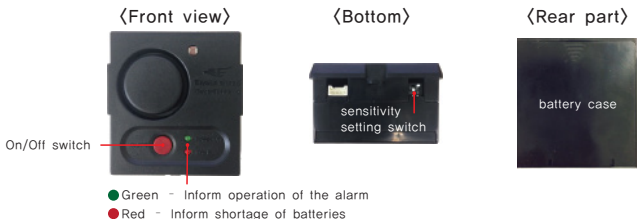

ON/OFF

- Open the door of the safe and operate the alarm by pressing On/Off button, (The alarm is activated only while the door is closed.)

Setting sensitivity

- Set 'Sensitive Type' or 'Insensitive Type' using sensitivity adjusting switch in the bottom of the alarm.
- Set 'Insensitive Type' if the vibration of vehicles or trains is made frequently in the area near the safe.



Cancelling emergency alarm sound

- Press Start button and input password to cancel the alarm sound automatically.
- In case the alarm sounds repeatedly after cancellation, open the door widely.

Replacing dry batteries

- Switch off the alarm and pull the alarm while it is being lifted a little bit.
- Open the battery cover in the rear part of the alarm and insert new dry batteries following polarity indicator.

The alarm sounds when;

- the door of the safe is impacted or tilted;
- the password makes error 5 times consecutively;
- 5 minutes have been passed after the door has been opened.

Connecting adapter

Basically, the product uses adapter.
Insert adapter terminal in DC terminal in the left bottom in the rear part of the safe.

- ! Be careful not to have adapter cable pinned beneath the safe.
- Check to ensure that the connector has been inserted completely.

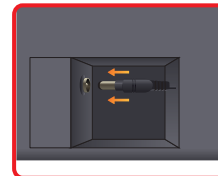

〈Back view〉

Password registration (Change)

- ! Changing password is possible only when the doors is opened and after change password, close the door after make sure that the door is opened using new password while the door is open.
- When you fail in password registration, try again from the beginning.

- 4 to 20 digits can be used for password registration.

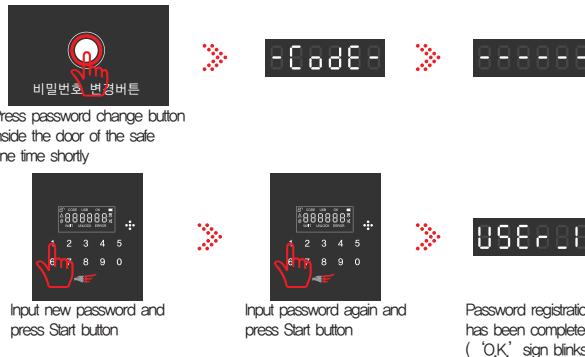

Password registration (Change) for inner safe

1. Press password change button behind the door of the safe while the door is open.
2. Input new password (6 digits). (Alarm sounds when the change has been completed.)
3. While the door is open, check if the door is opened using new password and close the door.